

LIFE IS A COLLECTION OF EXPERIENCES
LET US BE YOUR GUIDE

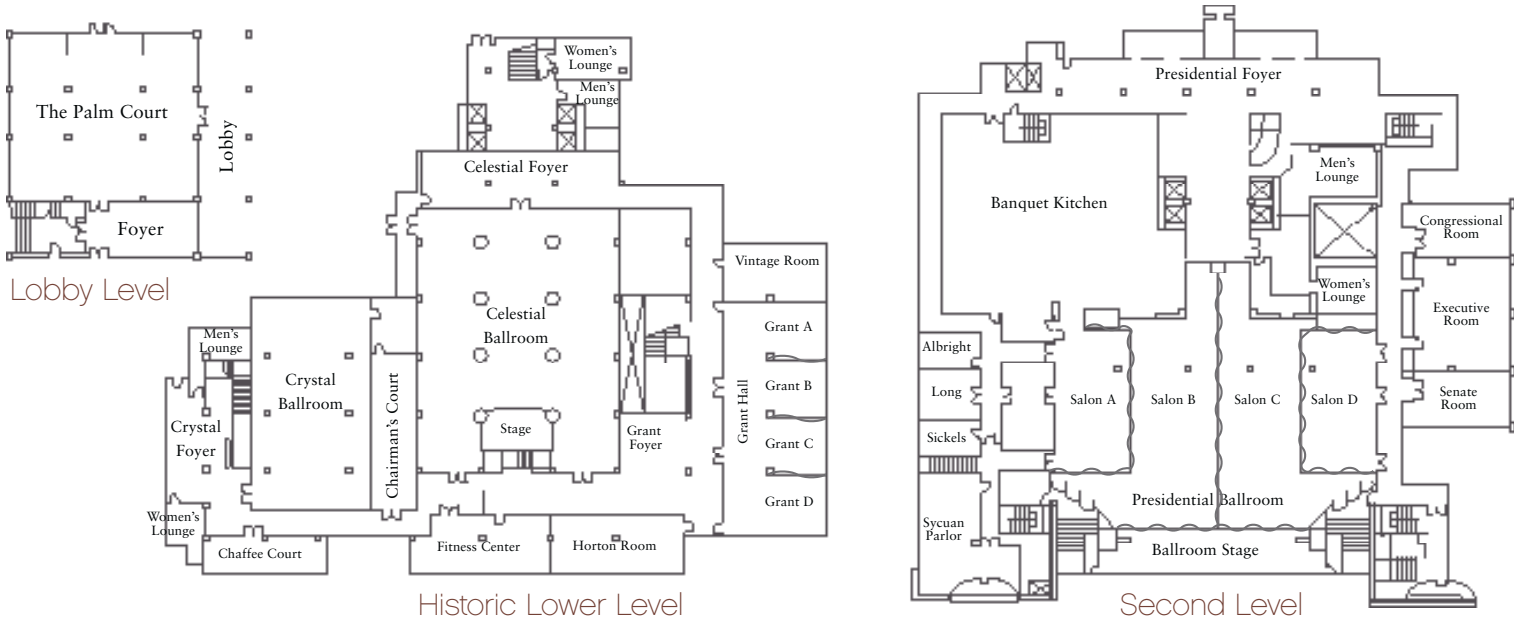

HISTORIC LOWER LEVEL	DIMENSIONS	TOTAL SQ FT	CEILING HEIGHT	RECEPTION	THEATER	CLASSROOM	BANQUET	CRESCENT	U SHAPE
Celestial Ballroom (w/ stage)	64' X 88'	5,632	11'	500	280	200	300	80	45
Celestial Ballroom (stage)	12' X 7'	204	10'	-	-	-	-	-	-
Celestial Foyer	20' X 61'	1,220	9'	150	-	-	-	-	-
Vintage Boardroom	15' X 31'	465	9' 6"	-	-	-	18	-	-
Grant Hall	35' X 78'	2,730	9' 6"	240	160	100	150	-	51
Grant A, B, C or D	20' X 35'	700	9' 6"	60	50	24	40	16	21
Grant Foyer	22' X 28'	816	9' 6"	125	-	-	-	-	-
Horton Room	18' X 42'	756	9' 6"	75	50	28	50	21	27
Chairman's Court	14' X 54'	756	9' 6"	75	60	40	50	28	-
Chaffee Court	13' X 34'	442	9' 6"	30	25	12	20	-	-
Crystal Ballroom	37' X 72'	2,664	14'	250	225	100	150	77	50
Crystal Foyer	25' X 31'	775	9' 6"	100	-	16	-	-	-

LOBBY LEVEL	DIMENSIONS	TOTAL SQ FT	CEILING HEIGHT	RECEPTION	THEATER	CLASSROOM	BANQUET	CRESCENT	U SHAPE
Palm Court	65' X 57'	3,705	16'	350	225	80	250	56	36
Palm Court Foyer	38' X 16'	608	16'	100	n/a	-	-	-	-

SECOND LEVEL	DIMENSIONS	TOTAL SQ FT	CEILING HEIGHT	RECEPTION	THEATER	CLASSROOM	BANQUET	CRESCENT	U SHAPE
Presidential Ballroom (w/o stage)	75' X 108'	8,100	11' - 16'	900	800	400	650	280	54
Presidential Ballroom (stage)	16' X 74'	1,184	10' 12"	-	-	-	-	-	-
Presidential Foyer	20' X 107'	2,140	9'	350	-	-	-	-	-
Salon A or D	24' X 49'	1,176	11'	125	80	48	70	49	36
Salon B or C	28' X 69'	1,932	16'	225	200	120	130	70	40
Congressional Room	31' X 20'	620	9'	40	50	24	30	21	21
Executive Room	31' X 45'	1,395	9'	140	100	60	90	42	24
Senate Room	31' X 20'	620	9'	40	50	24	30	21	21
Albright Boardroom	13' X 19'	247	8' 6"	15	20	12	10	-	-
Long Boardroom	17' X 19'	323	8' 6"	20	30	15	20	-	-
Sickels Boardroom	12' X 19'	228	8' 6"	15	20	12	10	-	-
Sycuan Parlor	19' X 40'	1,026	9'	75	80	40	60	40	24

Square footage and capacities may vary due to architectural features and equipment required. 2010© Starwood Hotels & Resorts Worldwide, Inc. All rights reserved.